

.03 NEOPRENE GASKET

MOUNTING PLATE  
COLD-ROLLED STEEL  
PAINTED BLACK

ALUMINUM COLLAR  
BLACK ANODIZE

SWITCH SEAL  
CLEAR

TEFLON RING  
WHITE

2" DIA. BALL  
BLACK

BLUE ALUMINUM COVER

#6-32 MOUNTING SCREWS (X6)  
.25 MIN TO .38 MAX. ENGAGEMENT  
DEPTH BELOW CUSTOMER PANEL

STANDARDS AND ENVIRONMENTAL SPECIFICATIONS

TEMPERATURE RANGE: (-25 TO +80° C) STANDARD MODEL

SEALING RATING: NEMA 12 (IP54),  
PCB HAS CONFORMAL COATING

STANDARDS: CE, ROHS, FCC CLASS B COMPLIANT  
AND IPC 610 CLASS II

POWER: 25MA @ 5V TYPICAL.

WEIGHT:

- P PS/2 INTERFACE (6 PIN MINI DIN CONNECTOR, 9.5 FT. DEFAULT LENGTH)
- U USB INTERFACE (9.5 FT. DEFAULT LENGTH)
- 1 RS232 REF: DRAWING 811610 CABLE OPTION, 6.0 FT. DEFAULT LENGTH
- 2 RS422/RS485 (REQUIRES A CUSTOM PART No.)
- LOW TEMPERATURE & CONFORMAL COATING, DEFAULT
- Q RS232 OPTIONAL CABLE REF. 811610 (CUSTOM CABLE LEGACY ONLY)  
USE ONLY IF POWER OPTION IS "0"
- V STANDARD VIBRATION DAMPENING OPTION
- VI LIGHT VIBRATION DAMPENING OPTION
- GI OPTIONAL SHALLOW COVER (LEGACY)
- BLANK OR 3B 3 BUTTON PS/2 MOUSE (BLANK = DEFAULT)
- 2B 2 BUTTON PS/2 MOUSE OPTION. (LEGACY)
- MSOF MICROSOFT SERIAL MOUSE (RS232 LEGACY)
- 0 STANDARD
- 1 OPTIONAL RS232 POWER ADAPTOR CABLE

NOTE DIMENSIONS ARE IN INCHES

CTI ELECTRONICS CORPORATION		
WWW.CTIELECTRONICS.COM		
NEMA 12 (IP54) PANEL MOUNT INDUSTRIAL TRACKBALL 2.0" DIAMETER T1003 SERIES		
761662		SCALE 1-1
SHEET 1 OF 2		DRAWN BY
APPROVED	DATE 06-07-17	PSB
COPYRIGHT 2017 CTI ELECTRONICS CORP. SPECIFICATIONS SUBJECT TO CHANGE WITHOUT NOTICE		

ORDERING INFORMATION:

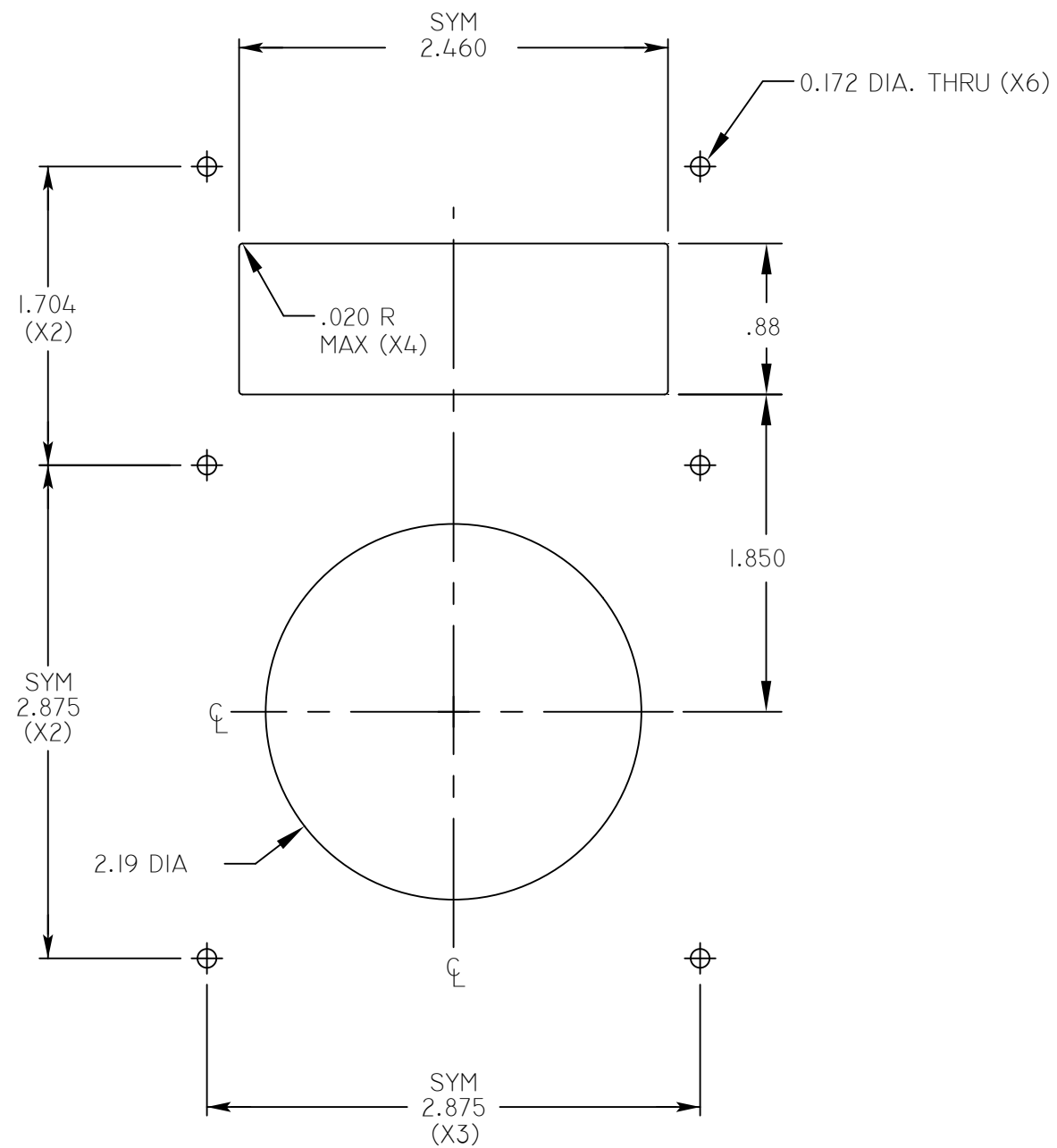

PANEL CUTOUT DETAIL

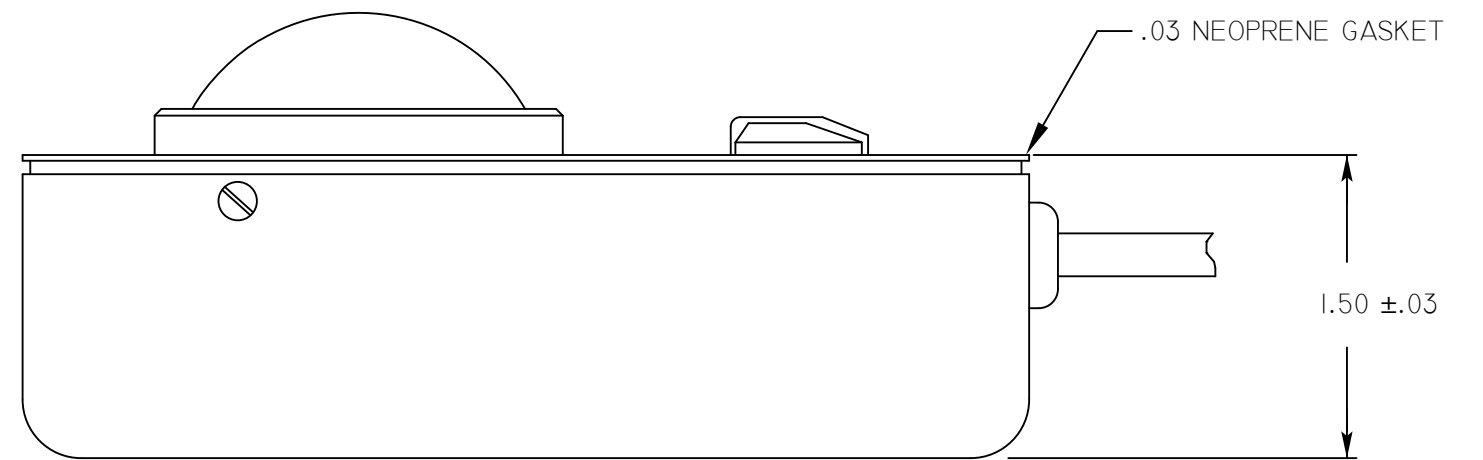

OPTIONAL SHALLOW COVER  
MODEL TIXX3GI (SPECIAL ORDER)

NOTE DIMENSIONS ARE IN INCHES

CTI ELECTRONICS CORPORATION

WWW.CTIELECTRONICS.COM

NEMA 12 (IP54) PANEL MOUNT  
 INDUSTRIAL TRACKBALL 2.0" DIAMETER  
 T1003 SERIES

761662

SHEET 2 OF 2

SCALE 1-1

APPROVED

DATE 06-07-17

DRAWN BY  
 PSB

COPYRIGHT 2017 CTI ELECTRONICS CORP.  
 SPECIFICATIONS SUBJECT TO CHANGE WITHOUT NOTICE