

-40°C TO +80°C  
 NEMA 4/IP66  
 5.3 oz., 151g  
 CE, RoHS, REACH, IPC 610 CLASS II COMPLIANT

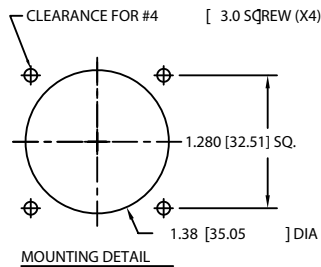
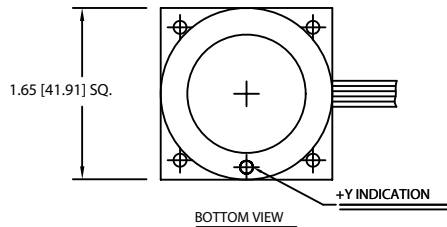

ORDERING INFORMATION

- 1 4-40 THREADED INSERTS
- 3 3 MM THREADED INSERTS

Z CONFORMAL COATING ON PCB  
 R CONDUCTIVE BOOT  
 RF CONDUCTIVE BOOT AND FERRITE BEAD  
 (CUSTOMER ENCLOSURE NEEDS TO BE SHIELDED)

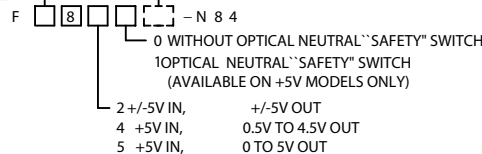

NOTES:

REF DWG 761718 FOR ELECTRICAL DETAILS  
 DIMENSIONS ARE IN INCHES [MILLIMETERS]

CTI <u>ELECTRONICS CORPORATION</u> WWW.CTIELECTRONICS.COM	
NEMA 4 (IP66) INDUSTRIAL JOYSTICK F1800-N84 3 AXES SERIES	
761810	DATE 07-20-16 DRAWN BY PSB
APPROVED	SHEET 1 OF 1
COPYRIGHT 2016 CTI ELECTRONICS CORP. SPECIFICATIONS SUBJECT TO CHANGE WITHOUT NOTICE	