

CTI Electronics Sealed Keyboard or Industrial Mouse.
Model Number KI9000, KI8000 or KI6000 Series Sealed Keyboards
Model Number M2 or M9 Series Industrial Mouse®

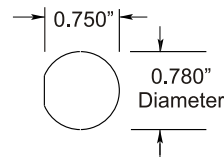

PANEL CUTOUT
DETAIL

- Temperature Rating -55° C to 125° C
- NEMA 4 Sealed
- Chemical Resistance Impervious to gasoline, transmission and brake fluids, industrial oils, lubricants, and corrosive agricultural chemicals.
- Rated for 300 mate / unmate cycles.
- Connector Housings U.L. Recognized.
- Contacts Gold Plated.
- Gaskets Black Nitrile Rubber.

Notes:

- 1.) Cable Length Dimensions are nominal.
- 2.) Plug Shell and Socket Shell are soldered to the cables as shown at factory. Customer must cutout panel as shown and install Socket Shell using Hex Nut and Rubber Gasket.
- 3.) Sealed Customer Enclosures by Others
- 4.) For use with Panels up to .1875" thick.
- 5.) Ordering this option will include the following items: Plug Shell, Socket Shell, Captive Dust Cover, Hex Nut, and Rubber Gasket.

ORDERING INFORMATION :

** Select Length of the cable from Plug Shell to Keyboard / Mouse. Specify at time of order.

Available Lengths	Model Number Suffix (reference)
1 Foot	W1
2 Feet	W2
3 Feet	W3
4 Feet	W4
5 Feet	W5

Consult Factory for custom configurations.

Not to Scale

Copyright© 2000 CTI Electronics Corporation

CTI REF: 761705

CTI ELECTRONICS CORPORATION
110 Old South Ave. Stratford, CT 06615 - Tel 203 / 386-9779 - Fax 203 / 378-4986 - www.ctielelectronics.com

Cable Drawing - Waterproof through Panel Connector Option for Keyboard or Mouse "W" Series

REVISION: B	DATE: 11/13/00	A820029 Sheet 1 of 1
APPROVED:	DRAWN: Ray Kirmaier	