

CTI Electronics Sealed Keyboard and Industrial Mouse® or Sealed Keyboard and ARROWMOUSE™ Combination.
 Model Number KIF Series
 Model Number KIA Series
 Model Number KIT Series

Plug Shell twists and locks into Socket Shell for secure and sealed electrical connection. When Keyboard or Mouse is not in use, the captive Dust Cover can be used to help protect the Socket Shell from contaminants.

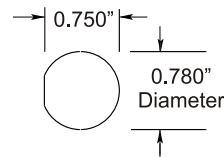

PANEL CUTOUT
DETAIL

- Temperature Rating -55° C to 125° C
- NEMA 4 Sealed
- Chemical Resistance Impervious to gasoline, transmission and brake fluids, industrial oils, lubricants, and corrosive agricultural chemicals.
- Rated for 300 mate / unmate cycles.
- Connector Housings U.L. Recognized.
- Contacts Gold Plated.
- Gaskets Black Nitrile Rubber.

Notes:

- 1.) Cable Length Dimensions are nominal.
- 2.) Plug Shell and Socket Shell are soldered to the cables as shown at factory. Customer must cutout panel as shown and install Socket Shell using Hex Nut and Rubber Gasket.
- 3.) Sealed Customer Enclosures by Others
- 4.) For use with Panels up to .1875" thick.
- 5.) Ordering this option will include the following items: Plug Shell, Socket Shell, Captive Dust Cover, Hex Nut, and Rubber Gasket.

ORDERING INFORMATION :

** Select Length of the cable from Plug Shell to Keyboard / Mouse. Specify at time of order.

Available Lengths	Model Number Suffix (reference)
1 Foot	W1
2 Feet	W2
3 Feet	W3
4 Feet	W4
5 Feet	W5

Consult Factory for custom configurations.

Not to Scale

Copyright© 2000 CTI Electronics Corporation

CTI REF: 761705

CTI ELECTRONICS CORPORATION
 110 Old South Ave. Stratford, CT 06615 - Tel 203 / 386-9779 - Fax 203 / 378-4986 - www.ctielelectronics.com

Cable Drawing - Waterproof through Panel Connector Option for Combination Keyboard and Mouse "W" Series

REVISION: B	DATE: 11/13/00	A820030 Sheet 1 of 1
APPROVED:	DRAWN: Ray Kirmaier	